

100
50
20
10
0

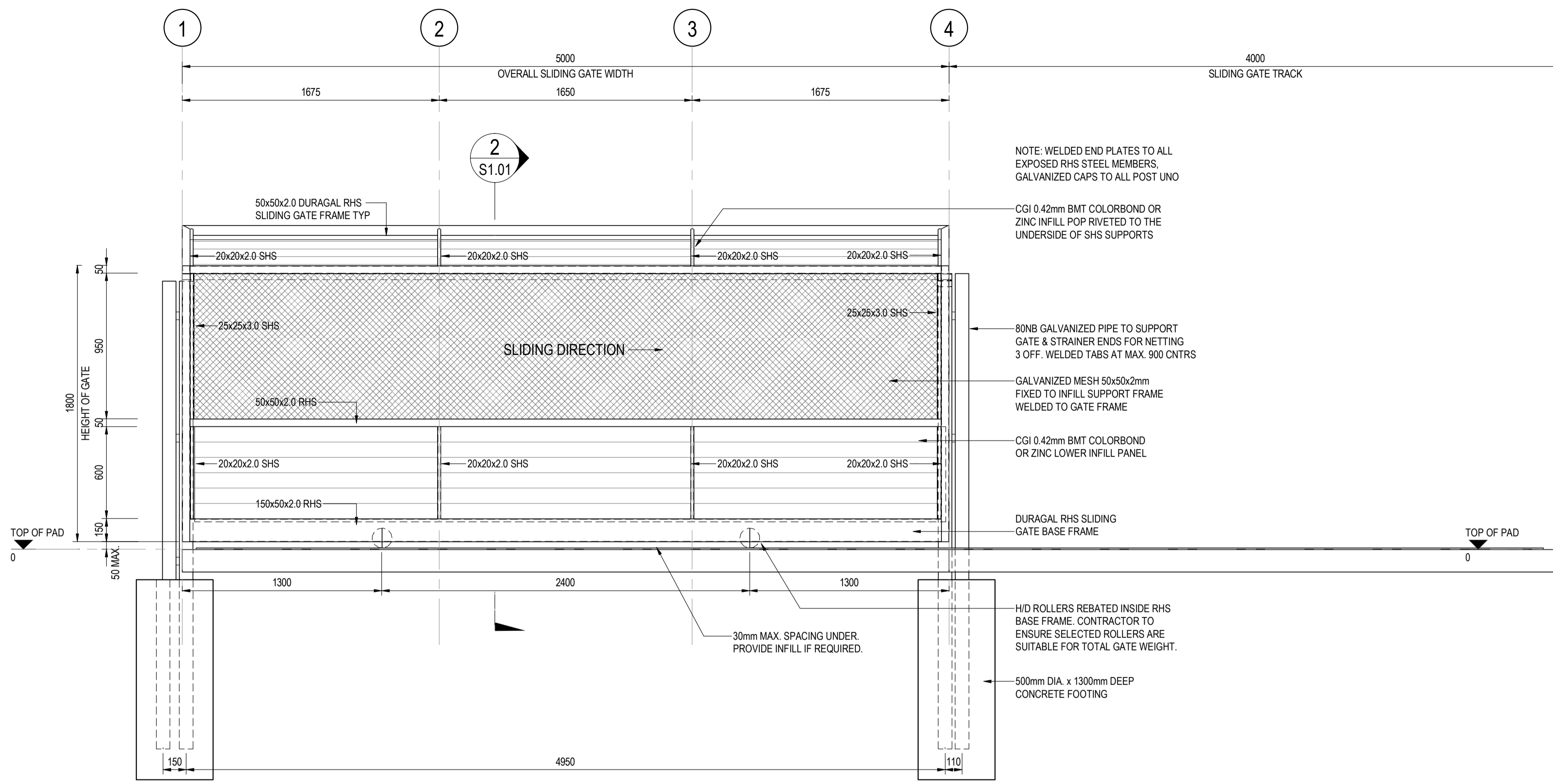

ELEVATION 1
1:20
S1.01

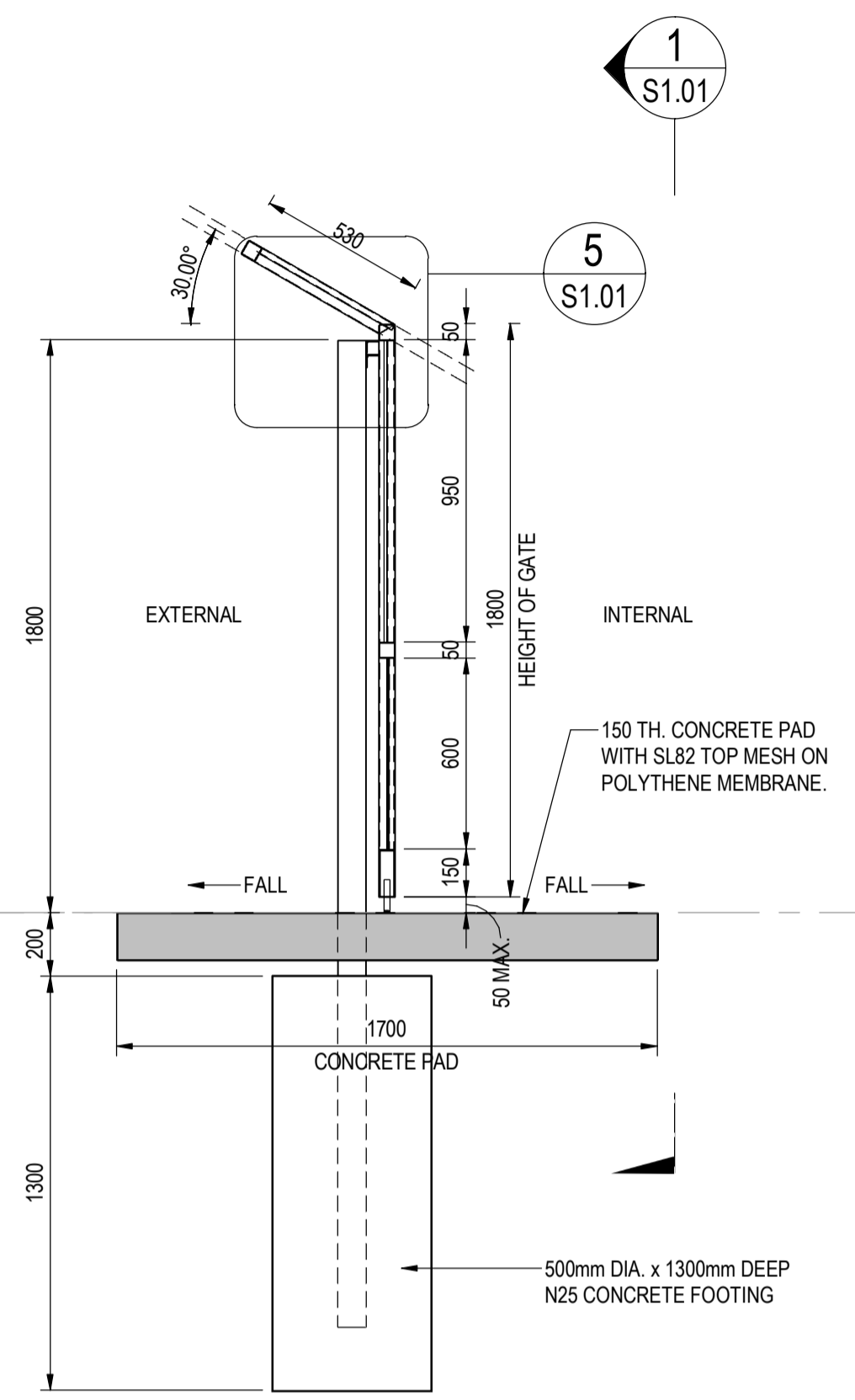

SECTION 2
1:20
S1.01

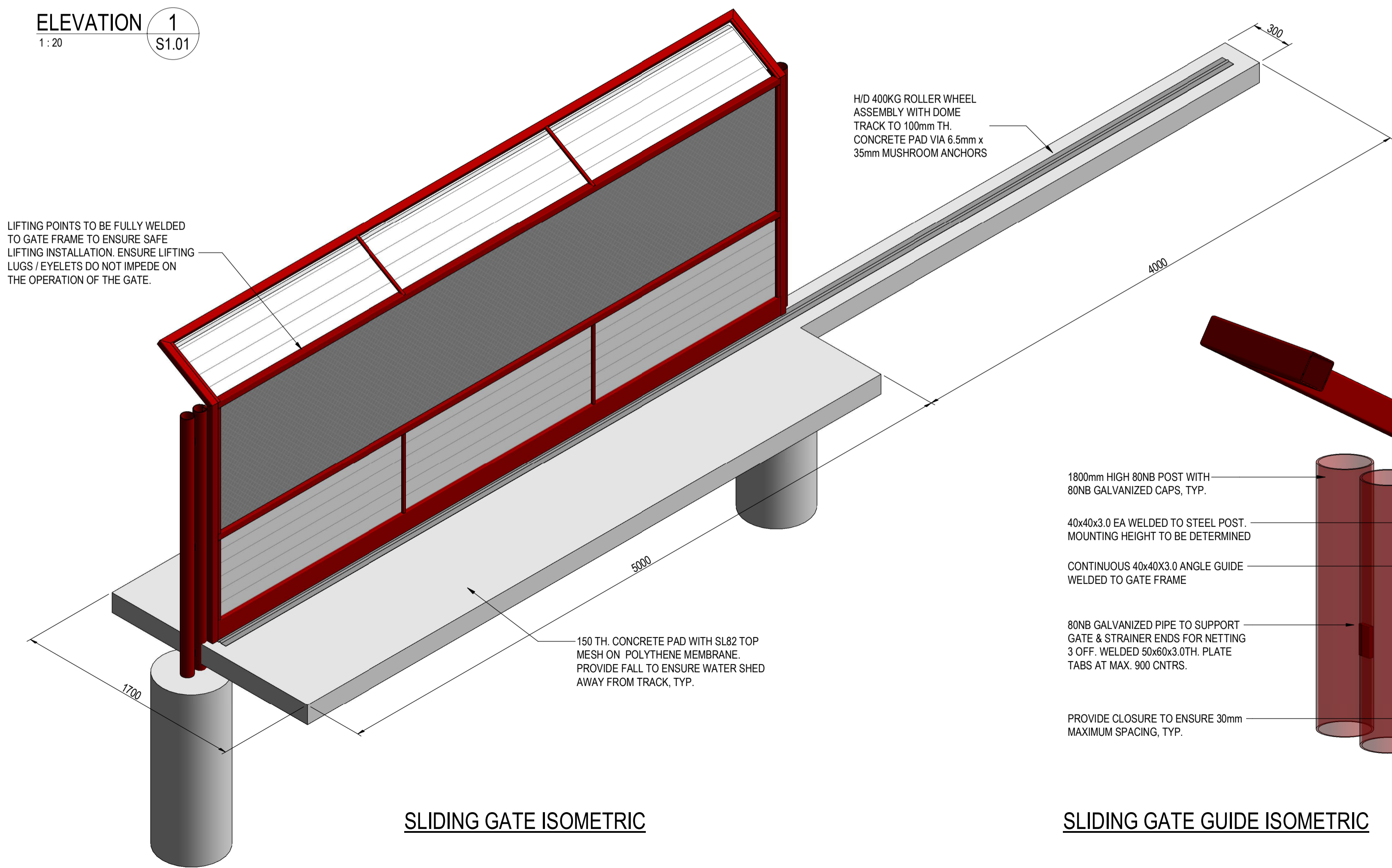

SLIDING GATE ISOMETRIC

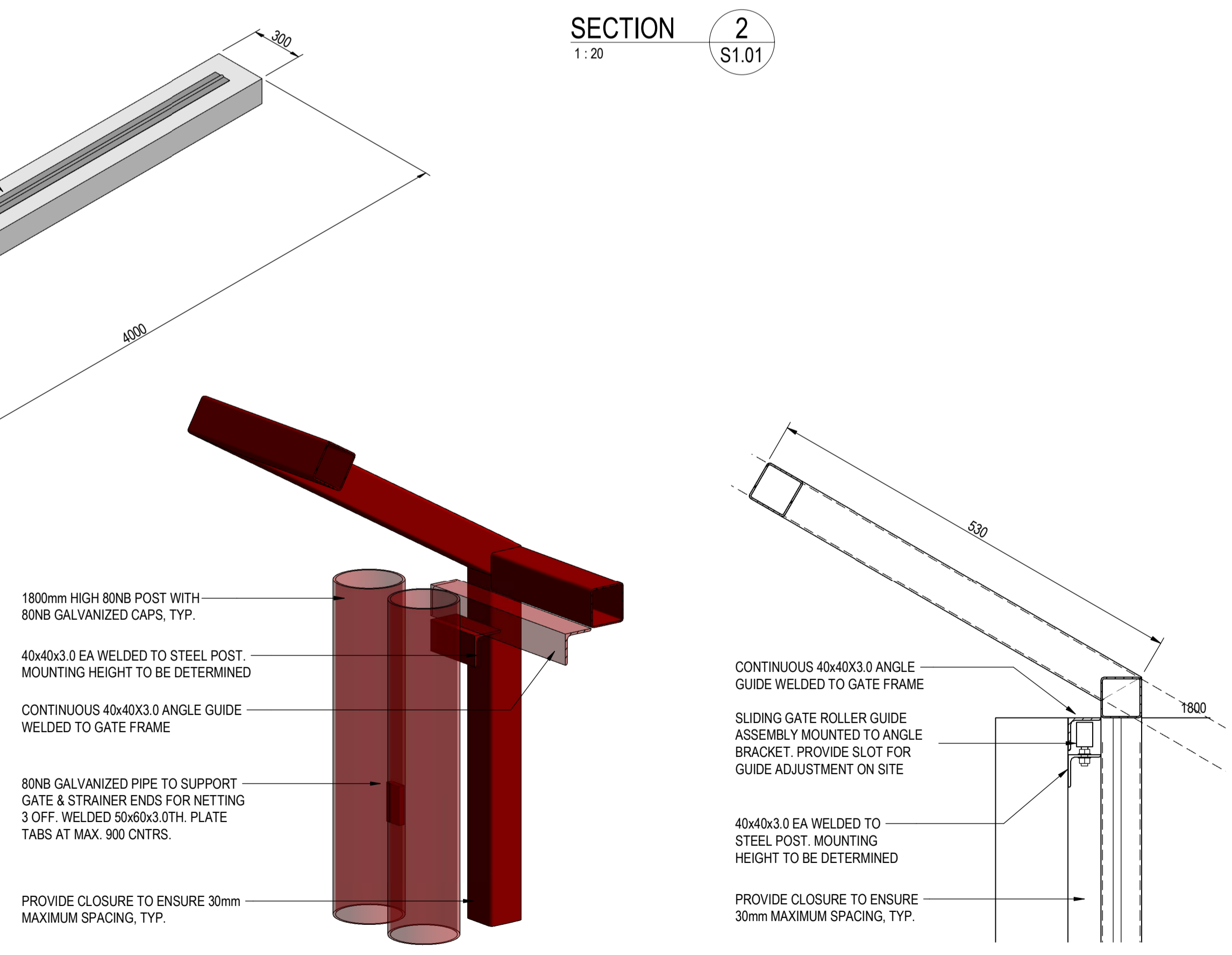

SLIDING GATE GUIDE ISOMETRIC

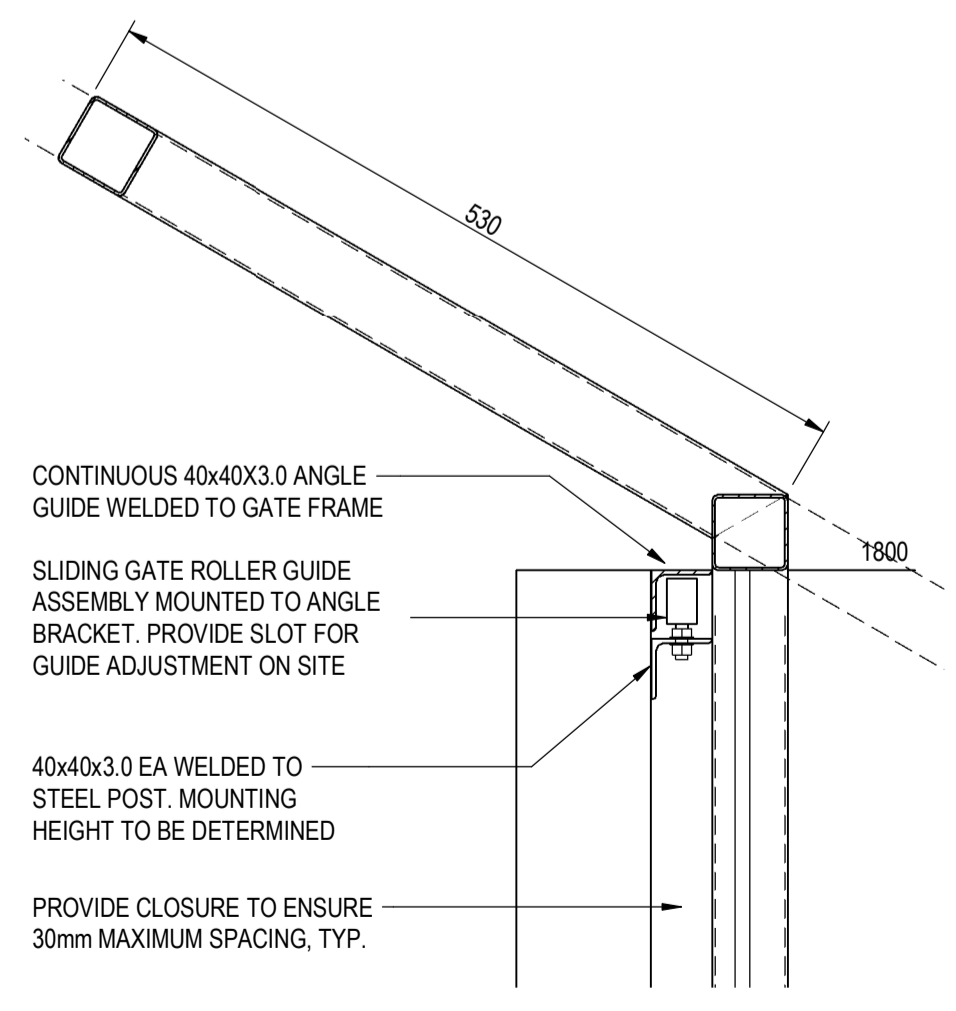

DETAIL 5
1:5
S1.01

- GENERAL NOTES**
- GATE MONITORING SYSTEMS TO BE DESIGNED AND PROVIDED BY CLIENT.
 - GATE LOCKING MECHANISM & HARDWARE CONTRACTOR TO ALLOW FOR THE SUPPLY & INSTALLATION OF AN APPROVED LOCKING MECHANISM & HARDWARE. INSTALLATION TO BE DETERMINED BY CONTRACTOR PRIOR TO FABRICATION.
 - LIFTING POINT(S) LIFTING POINTS TO BE FULLY WELDED TO GATE FRAME TO ENSURE SAFE LIFTING INSTALLATION. ENSURE LIFTING LUGS / EYELETS DO NOT IMPEDE ON THE OPERATION OF THE GATE.
 - GUIDE ROLLER ASSEMBLY SLIDING GATE HEAD GUIDE INSTALLATION HEIGHT TO BE DETERMINED BY CONTRACTOR PRIOR TO FABRICATION.
 - ANTI LIFT-OFF / GATE RECEIVER CONTRACTOR TO ALLOW FOR THE SUPPLY & INSTALLATIONS OF A SUITABLE ANTI LIFT-OFF RECEIVER. INSTALLATION HEIGHT TO BE DETERMINED BY CONTRACTOR PRIOR TO FABRICATION.
 - GATE ROLLERS REBATED HEAVY DUTY GATE ROLLERS WITH 30mm MAX. SPACING UNDER. CONTRACTOR TO ENSURE SELECTED ROLLERS ARE SUITABLE FOR TOTAL GATE WEIGHT.
 - SECONDARY GATE FRAMING CONTRACTOR TO ENSURE THE FINISHED FACE OF ALL SECONDARY INFILL SUPPORT FRAMING SET TO ALIGN WITH EXTERNAL FACE OF GATE FRAME. NOTE INFILL FRAMING SIZES MAY VARY.

- CONCRETE:**
- STANDARD:** ALL WORK TO BE IN ACCORDANCE WITH AS 3600.
 - REINFORCEMENT:** ALL REINFORCEMENT TO BE IN ACCORDANCE WITH AS 4671. N DENOTES D500N DEFORMED RIBBED 500 MPa NORMAL DUCTILITY. R DENOTES 250N ROUND 250 MPa NORMAL DUCTILITY. MESH TO BE D500L DEFORMED RIBBED 500 MPa LOW DUCTILITY.
 - FABRIC LAPPING:** FABRIC END AND SIDE LAPS ARE TO BE PLACED STRICTLY IN ACCORDANCE WITH THE MANUFACTURER'S REQUIREMENTS TO ACHIEVE A FULL TENSILE LAP. FABRIC SHALL BE LAID SO THAT THERE IS A MAXIMUM OF 3 LAYERS AT ANY LOCATION.

4. COVER:

ELEMENT	COVER (mm)
EXTERNAL GROUND SLABS	30 TOP, 50 EDGE

5. STRENGTH (f_c):

ELEMENT	STRENGTH (f _c)
FOOTINGS, UNLESS OTHERWISE NOTED.	N32

6. SLUMP

ELEMENT	SLUMP (mm)
ALL OTHER CONCRETE, UNLESS OTHERWISE NOTED.	80

- COMPACTION:** IMMERSION TYPE VIBRATORS TO BE USED TO COMPACT ALL CONCRETE.
- CURING:** SLABS SHALL BE CONTINUOUSLY CURED FOR FIRST 7 DAYS.
- STRIPPING:** FORMWORK TO REMAIN IN PLACE 7 DAYS AFTER POURING. THIS MAY BE REDUCED BY TESTING CONTROL SAMPLES AS PER THE SPECIFICATION.
- HOLD DOWN:** ALL HOLD DOWN BOLTS AND CAST IN ITEMS SHALL BE HOT DIPPED GALVANISED AND ACCURATELY LOCATED PRIOR TO CASTING INTO CONCRETE.
- ACID SULPHATE SOIL:** SULPHATE RESISTING (SR) CEMENT SHALL BE IN ALL CONCRETE IN CONTACT WITH SOIL.

REV	DATE	DESCRIPTION	BY	APPD
1	25.03.2022	ISSUED FOR CONSTRUCTION	DS	DK
0	07.03.2022	ISSUED FOR TENDER	DS	DK

STATUS: ISSUED FOR CONSTRUCTION

pritchard francis
civil and structural engineering consultants
430 Roberts Road
Subiaco WA 6008
PO Box 2150
Subiaco WA 6904
Telephone: (08) 9382 5111
admin@pfrng.com.au

CLIENT	NSW NATIONAL PARKS & WILDLIFE								
PROJECT	NSW PARKS CONSERVATION FENCING								
TITLE	SLIDING GATE DETAILS								
SCALE	As indicated @ A1	DATE	SEPT 2021	DESIGNED	JH	DRAWN	DS	CHECKED	JH
JOB No	21-259	DRG No	S1.01	REV	1				

PRINT IN COLOUR

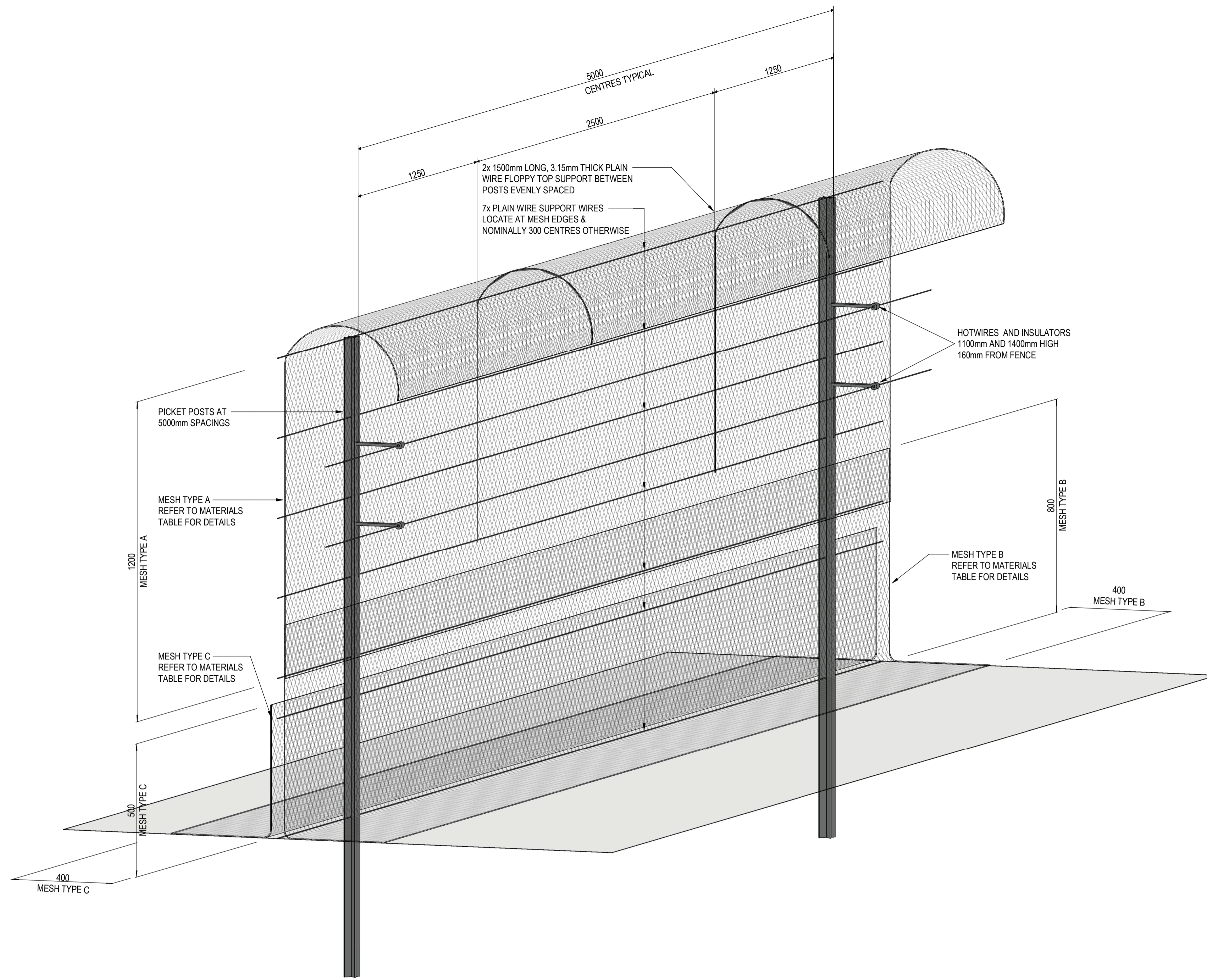

FENCE ISOMETRIC

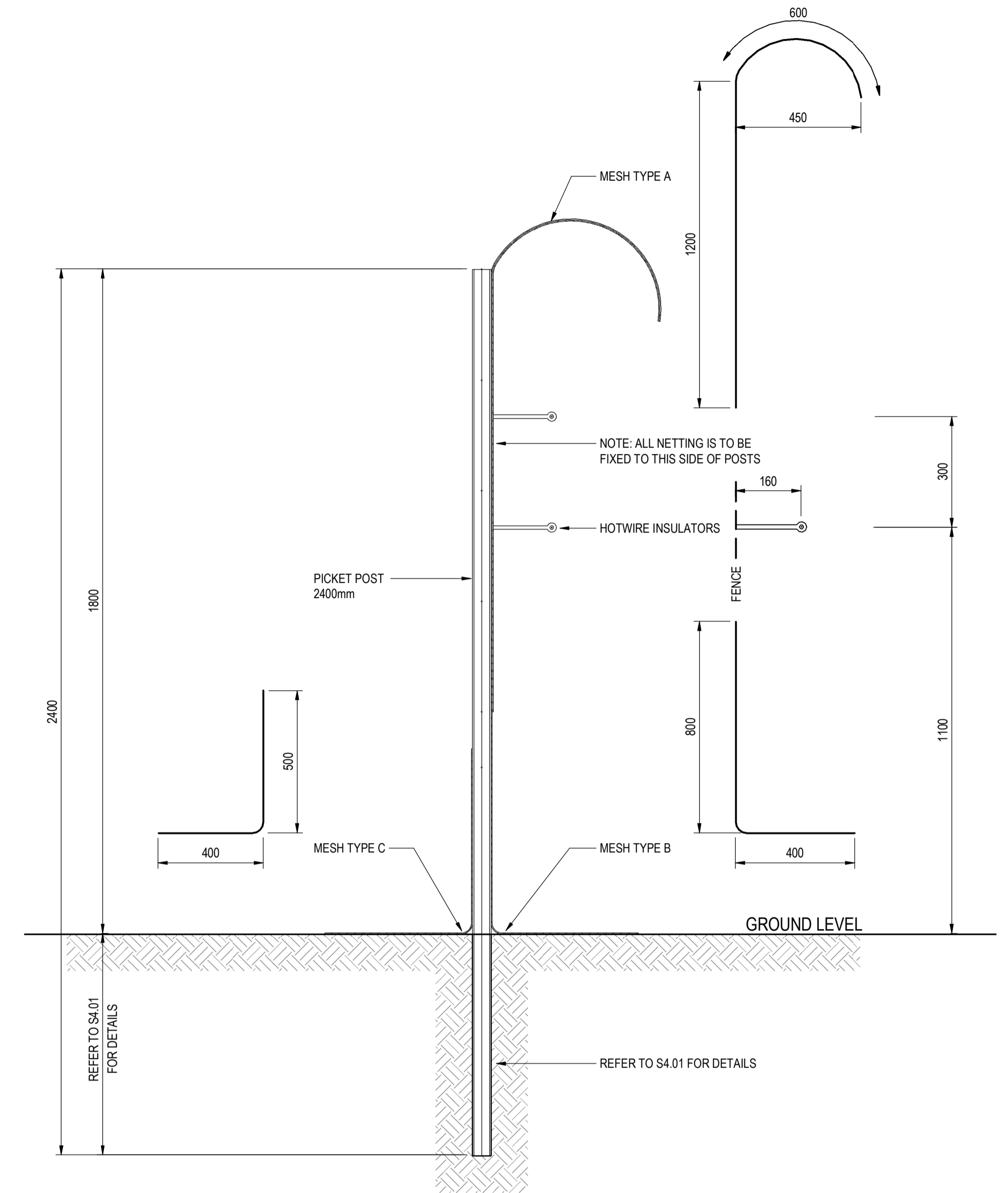

TYPICAL SECTION

1:10

MATERIALS GUIDE						
MARK	MATERIAL	COATING	GAUGE	DETAILS	COMMENTS	QUANTITY
A	1800mm NETTING	HEAVY GALVANISED OR BETTER	1.4mm	40mm APERTURE		
B	1200mm NETTING	HEAVY GALVANISED OR BETTER	1.4mm	30mm APERTURE		
C	900mm NETTING	HEAVY GALVANISED OR BETTER	1.4mm	30mm APERTURE	NETTING WRAPS AROUND PICKETS	
	2.5mm PLAIN WIRE (SUPPORT PLAINS)	HIGH TENSILE	2.5mm		7 SUPPORT WIRES	
	2.5mm PLAIN WIRE (SUPPORT PLAINS)	HIGH TENSILE	2.5mm		2 HOT WIRES	
	3.15mm PLAIN WIRE (FLOPPY TOP SUPPORTS)	HIGH TENSILE	3.15mm		TWO SPACED BETWEEN PICKETS	
	TIE WIRE				ROLLS OF TIE WIRE TO TIE PLAINS TO POSTS AND PICKETS	
	C-CLIPS	HEAVY GALVANISED/LONG LIFE			NETTING TO BE CLIPPED IN A MANNER TO MINIMISE OPENINGS EVERY 5m	
	PICKETS 2400mm	HEAVY GALVANISED				
	INTERMEDIATE POSTS 80nb	HEAVY GALVANISED			ALLOW FOR A POST EVERY 500m. SPACING OF INTERMEDIATES MAY VARY AND WILL BE FINALISED AT TIME OF ORDERING	
	STRAINER ASSEMBLIES (INCLUSIVE OF ALL FIXINGS): • MAIN POST 80nb • END POST 50nb • TOP RAIL 40nb	HEAVY GALVANISED			ALLOW FOR STRAINER ASSEMBLIES ON CORNERS AND GATES. QUANTITIES YET TO BE DETERMINED	
	INTERMEDIATE POSTS 40nb INCLUSIVE OF ALL NECESSARY FIXINGS	GALVANISED			USED WHERE THERE IS A SLIGHT ANGLE IN THE FENCE. ON INTERMEDIATE POST WHERE STRAINER ASSEMBLY IS NOT REQUIRED. FINAL QUANTITIES MAY VARY	
	HOT WIRE STAND-OFFS AND INSULATORS TO STAND WIRES 160mm OFF THE FENCE				TWO PER POST (INCLUDES ALL PICKETS, STRAINER POSTS AND INTERMEDIATE POSTS)	

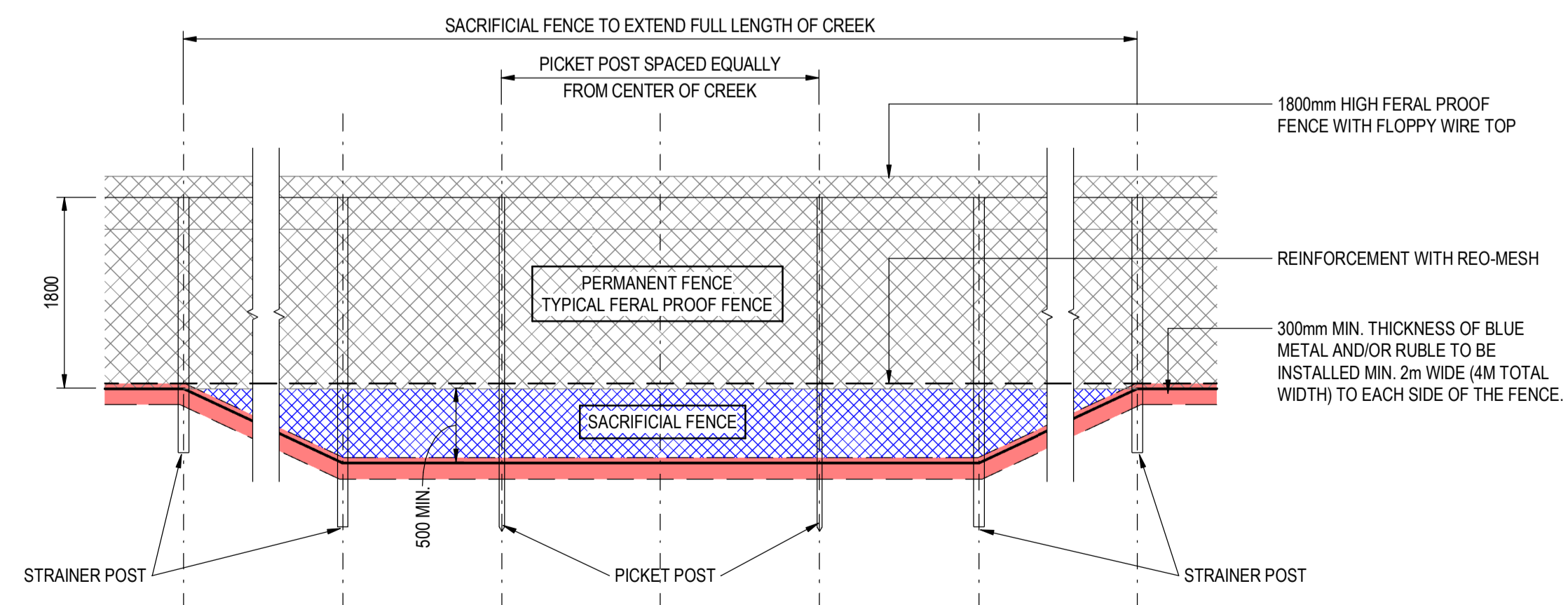

TYPICAL CREEK CROSSING LAYOUT

1:50

1	25.03.2022	ISSUED FOR CONSTRUCTION	LVA	DK
0	07.03.2022	ISSUED FOR TENDER	DS	DK
REV	DATE	DESCRIPTION	BY	APPD
STATUS ISSUED FOR CONSTRUCTION				

pritchard francis
civil and structural engineering consultants
430 Roberts Road
Subiaco WA 6008
PO Box 2150
Subiaco WA 6904
Telephone: (08) 9382 5111
admin@pfrng.com.au

CLIENT	NSW NATIONAL PARKS & WILDLIFE
PROJECT	NSW PARKS CONSERVATION FENCING
TITLE	FERAL PROOF FENCE DETAILS
SCALE	As indicated @ A1
DATE	SEPT 21
DESIGNED	JH
DRAWN	DS
CHECKED	JH
JOB No	21-259
DRG No	S3.01
REV	1

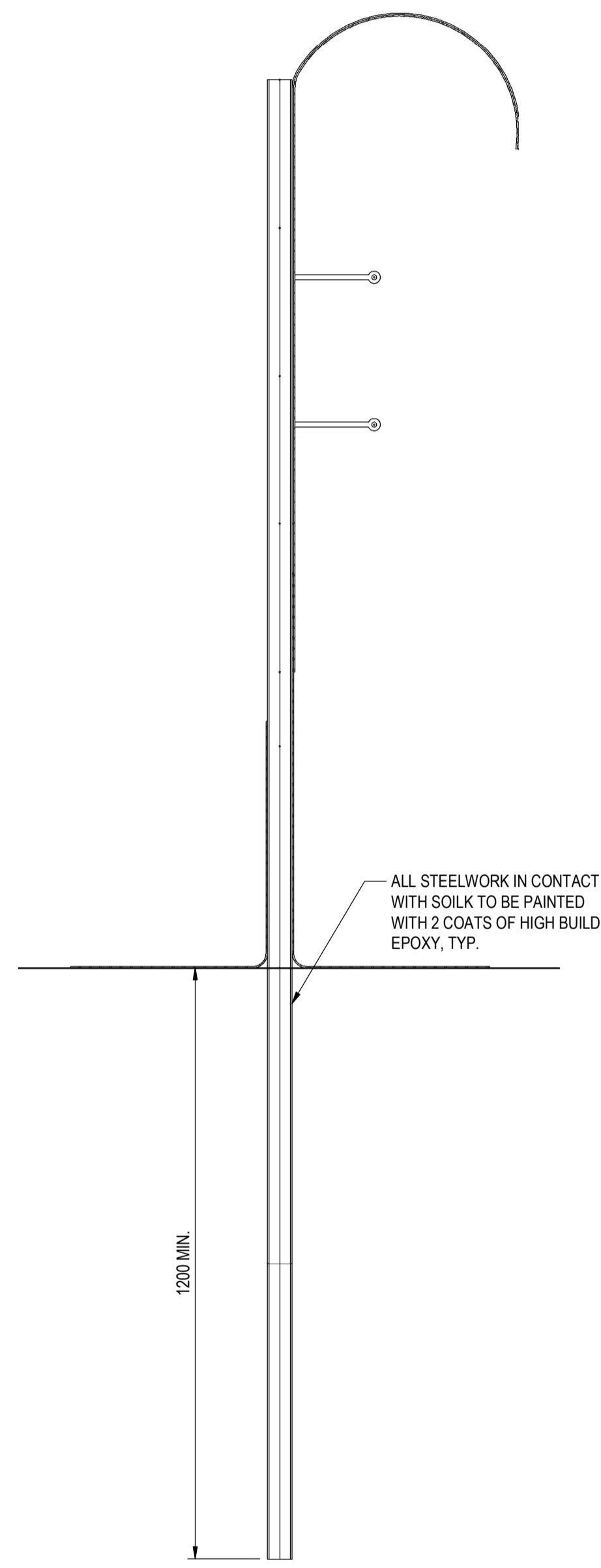
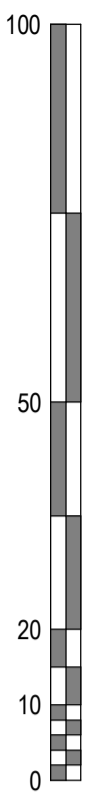

P1 AIR DRIVEN
1:10

ALL STEELWORK IN CONTACT WITH SOIL TO BE PAINTED WITH 2 COATS OF HIGH BUILD EPOXY, TYP.

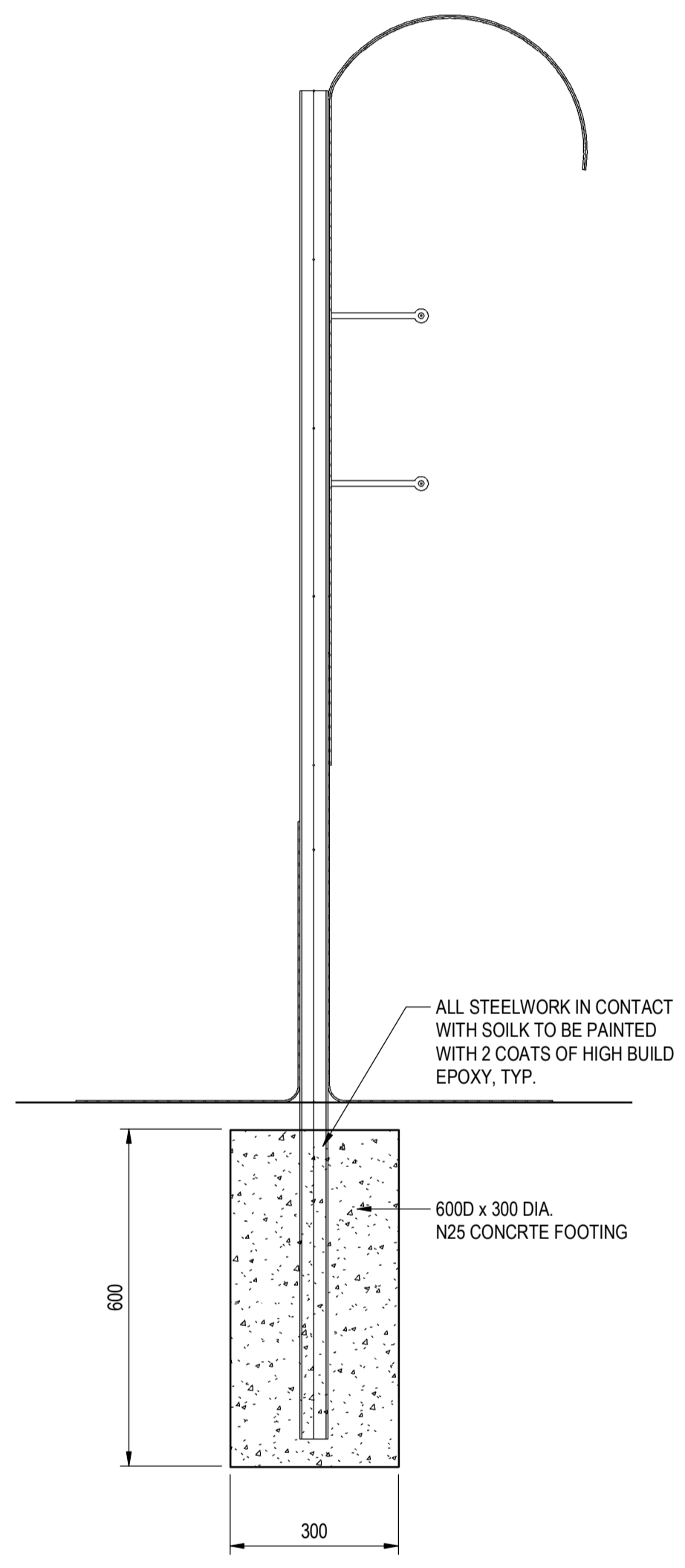

P2 CONCRETE FOOTING
1:10

ALL STEELWORK IN CONTACT WITH SOIL TO BE PAINTED WITH 2 COATS OF HIGH BUILD EPOXY, TYP.

6000 x 300 DIA N25 CONCRTE FOOTING

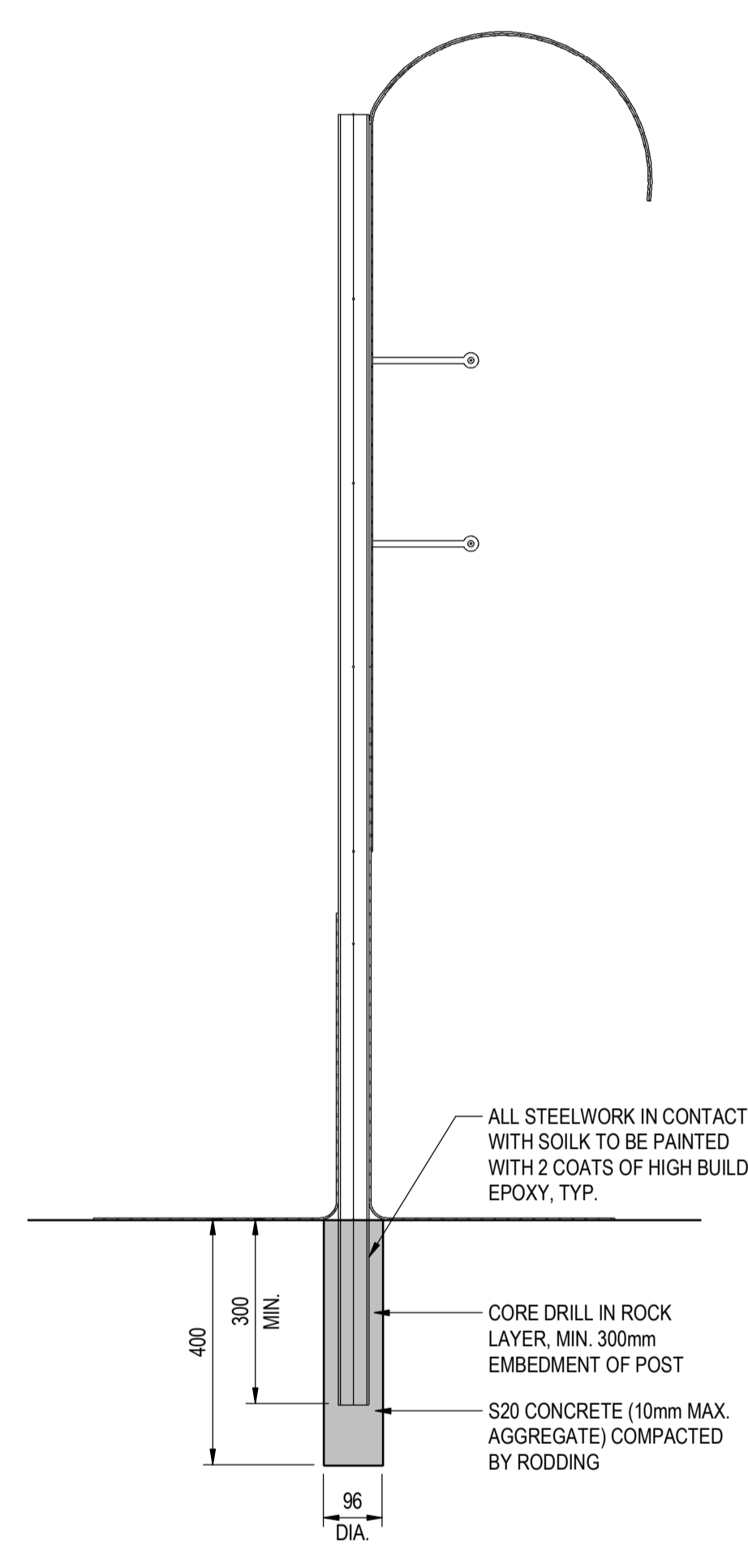

P3 ROCK EMBEDMENT
1:10

ALL STEELWORK IN CONTACT WITH SOIL TO BE PAINTED WITH 2 COATS OF HIGH BUILD EPOXY, TYP.

CORE DRILL IN ROCK LAYER, MIN. 300mm EMBEDMENT OF POST
S20 CONCRETE (10mm MAX. AGGREGATE) COMPACTED BY RODDING

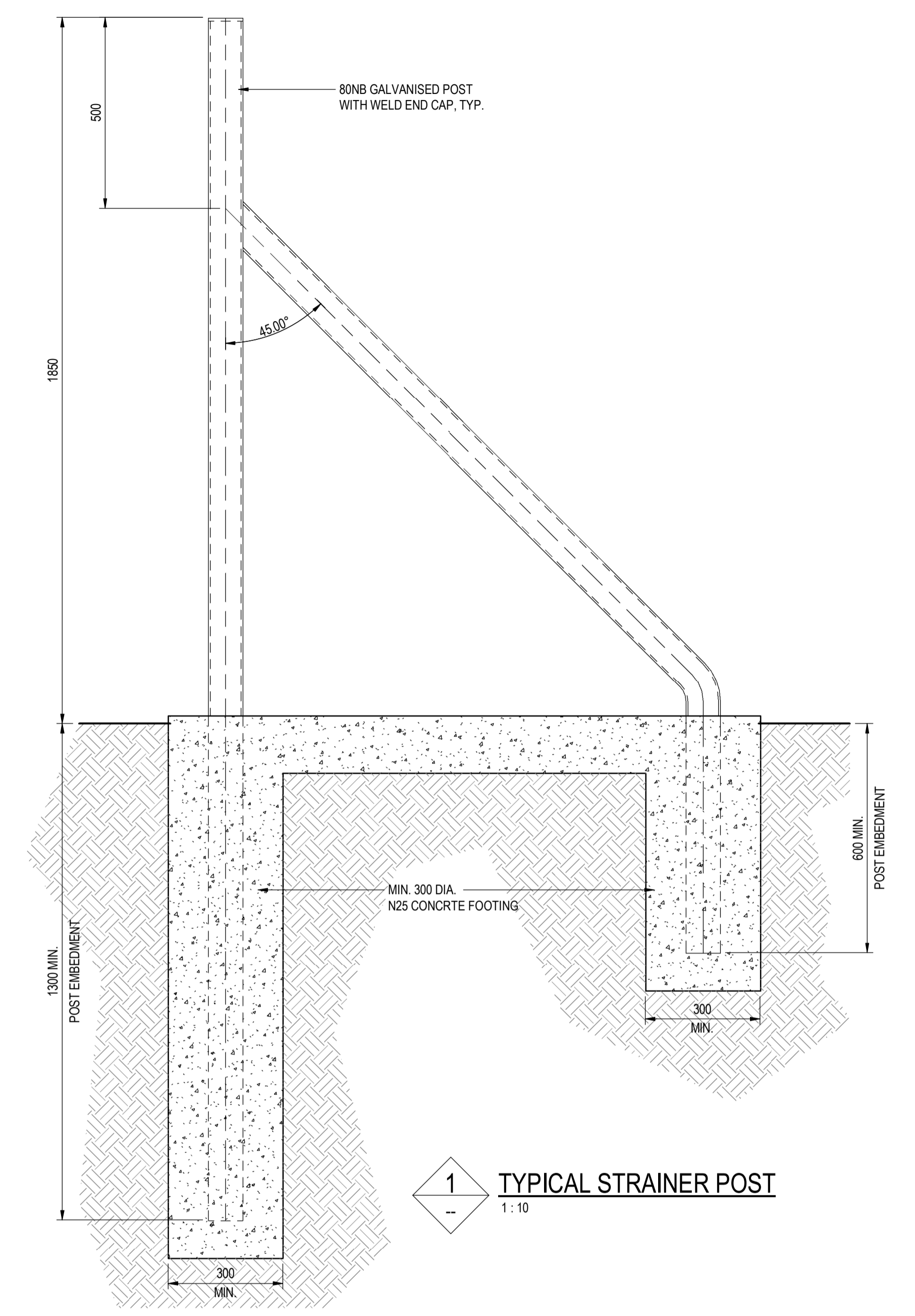

1 TYPICAL STRAINER POST
1:10

1	25.03.2022	ISSUED FOR CONSTRUCTION	LVA	DK
0	07.03.2022	ISSUED FOR TENDER	DS	DK
REV	DATE	DESCRIPTION	BY	APPD
STATUS				
ISSUED FOR CONSTRUCTION				

pritchard francis
civil and structural engineering consultants

430 Roberts Road
Subiaco WA 6008
PO Box 2150
Subiaco WA 6904
Telephone: (08) 9382 5111
admin@pfeng.com.au

CLIENT	NSW NATIONAL PARKS & WILDLIFE								
PROJECT	NSW PARKS CONSERVATION FENCING								
TITLE	POST DETAILS								
SCALE	1:10@A1	DATE	SEPT 21	DESIGNED	JH	DRAWN	DS	CHECKED	JH
JOB No	21-259	DRG No	S4.01	REV	1				

PRINT IN COLOUR

100
50
20
10
0

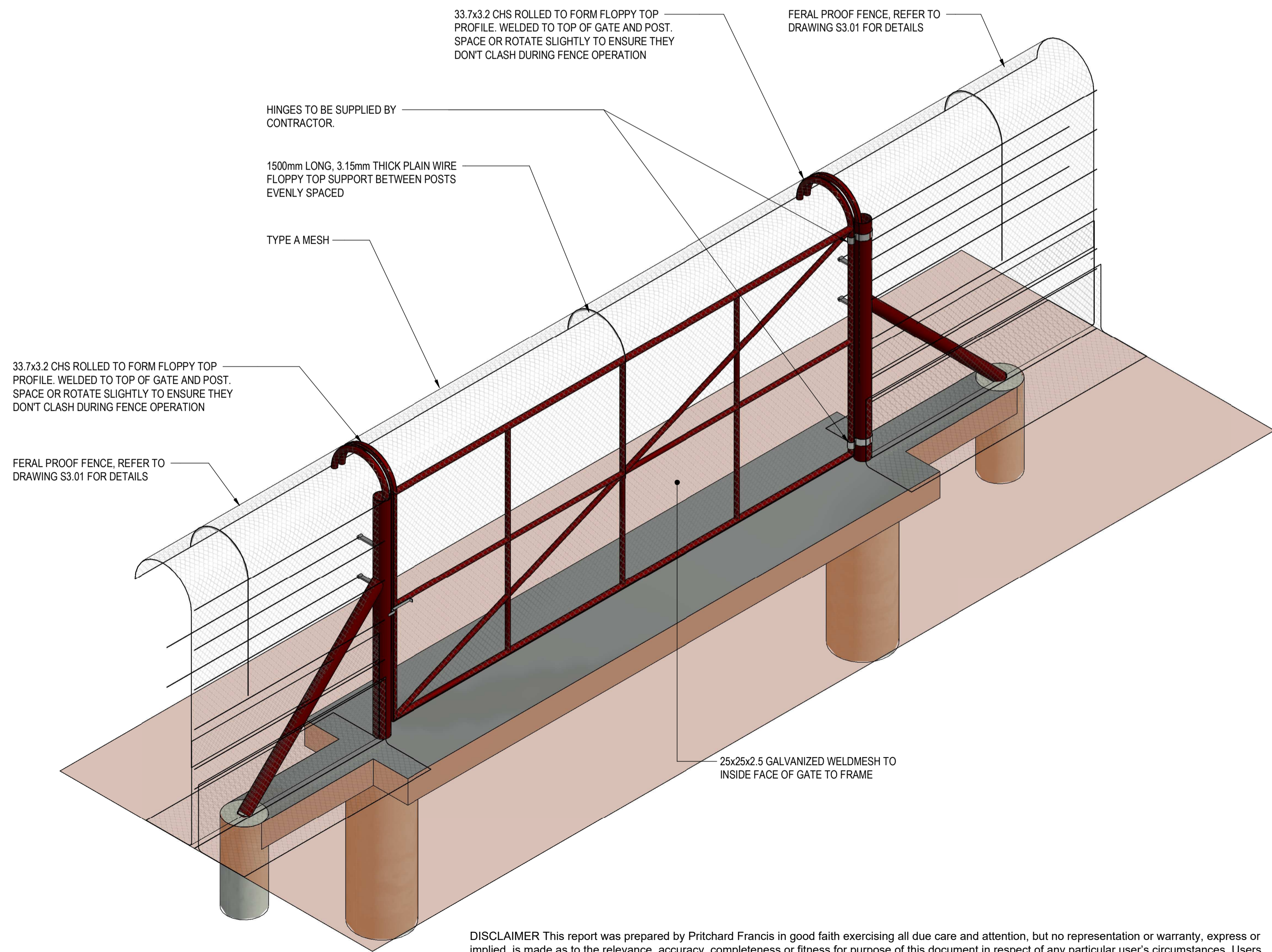
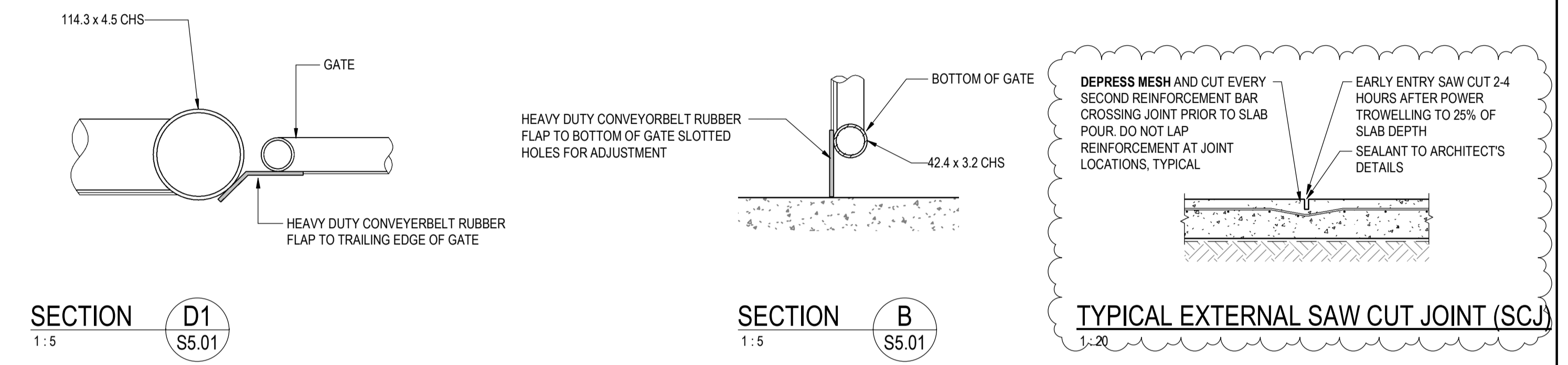
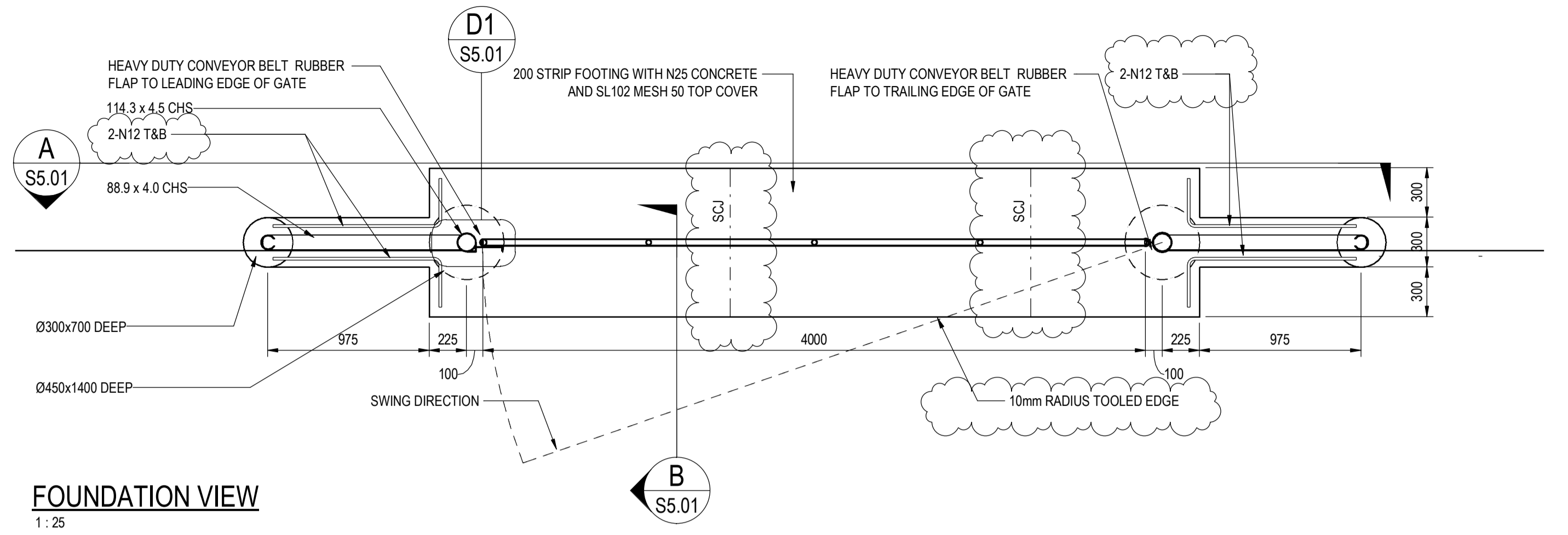
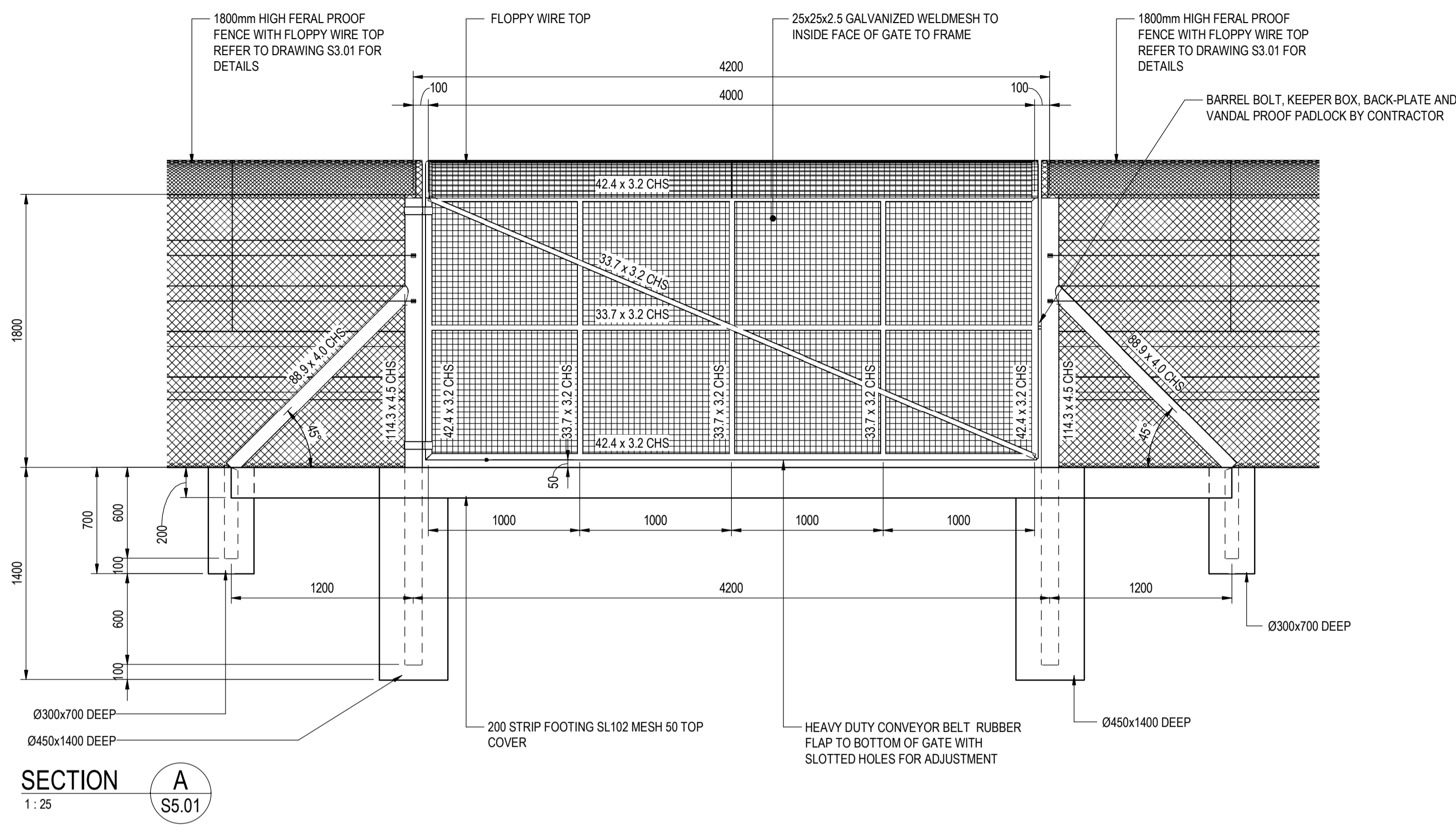

MATERIALS GUIDE						
MARK	MATERIAL	COATING	GAUGE	DETAILS	COMMENTS	QUANTITY
A	1000mm NETTING	HEAVY GALVANISED OR BETTER	1.4mm	40mm APERTURE		
	3.15mm PLAIN WIRE (FLOPPY TOP SUPPORTS)	HIGH TENSILE	3.15mm		SPACED BETWEEN POSTS	
	C-CLIPS	HEAVY GALVANISED/LONG LIFE			NETTING TO BE CLIPPED IN A MANNER TO MINIMISE OPENINGS	
	HOT WIRE STAND-OFFS AND INSULATORS TO STAND WIRES 160mm OFF THE FENCE				TWO PER POST	
	STRAINER POST MAIN POST 114NB BRACE 89NB	GALVANISED			INSTALL EITHER SIDE OF SWING GATE AS DETAILED	
	SWING GATE FRAME TOP AND BOTTOM RAIL 42NB VERTICALS 33NB DIAGONAL 33NB	GALVANISED			INSTALL AS DETAILED	

- CONCRETE:**
- STANDARD:** ALL WORK TO BE IN ACCORDANCE WITH AS 3600.
 - REINFORCEMENT:** ALL REINFORCEMENT TO BE IN ACCORDANCE WITH AS 4671. N DENOTES D500N DEFORMED RIBBED 500 MPa NORMAL DUCTILITY. R DENOTES 250N ROUND 250 MPa NORMAL DUCTILITY. MESH TO BE D500L DEFORMED RIBBED 500 MPa LOW DUCTILITY.
 - FABRIC LAPPING:** FABRIC END AND SIDE LAPS ARE TO BE PLACED STRICTLY IN ACCORDANCE WITH THE MANUFACTURER'S REQUIREMENTS TO ACHIEVE A FULL TENSILE LAP. FABRIC SHALL BE LAID SO THAT THERE IS A MAXIMUM OF 3 LAYERS AT ANY LOCATION.
- COVER:**
- | ELEMENT | COVER (mm) |
|-----------------------|-----------------|
| EXTERNAL GROUND SLABS | 50 TOP, 50 EDGE |
- STRENGTH (f_c):**
- | ELEMENT | STRENGTH (f _c) |
|-----------------------------------|----------------------------|
| FOOTINGS, UNLESS OTHERWISE NOTED. | N32 |
- SLUMP**
- | ELEMENT | SLUMP (mm) |
|---|------------|
| ALL OTHER CONCRETE, UNLESS OTHERWISE NOTED. | 80 |
- COMPACTION:** IMMERSION TYPE VIBRATORS TO BE USED TO COMPACT ALL CONCRETE.
 - CURING:** SLABS SHALL BE CONTINUOUSLY CURED FOR FIRST 7 DAYS.
 - STRIPPING:** FORMWORK TO REMAIN IN PLACE 7 DAYS AFTER POURING. THIS MAY BE REDUCED BY TESTING CONTROL SAMPLES AS PER THE SPECIFICATION.
 - HOLD DOWN:** ALL HOLD DOWN BOLTS AND CAST IN ITEMS SHALL BE HOT DIPPED GALVANISED AND ACCURATELY LOCATED PRIOR TO CASTING INTO CONCRETE.
 - ACID SULPHATE SOIL:** SULPHATE RESISTING (SR) CEMENT SHALL BE IN ALL CONCRETE IN CONTACT WITH SOIL.

- GENERAL NOTES:**
- PROPRIETARY ITEMS**
ALL PROPRIETARY ITEMS SHALL BE INSTALLED IN ACCORDANCE WITH THE MANUFACTURER'S SPECIFICATIONS.
GATE LOCKING MECHANISM:
- THE CONTRACTOR TO ALLOW FOR THE SUPPLY & INSTALLATION OF AN APPROVED LOCKING MECHANISM. INSTALLATION TO BE DETERMINED BY CONTRACTOR PRIOR TO FABRICATION.
HINGES:
- THE CONTRACTOR SHALL SUPPLY AND INSTALL SUITABLE HINGES TO ALLOW A SMOOTH FENCE OPERATION WITH NO SAGGING OR LOOSENING OVER TIME.
 - CORROSION PROTECTION**
ALL DAMAGE TO GALVANISED COATING DURING TRANSPORT OR SITE WELDING SHALL BE MADE GOOD WITH 2 COATS OF A ZINC RICH EPOXY PRIMER.
 - HOLLOW SECTIONS**
TO BE SEALED WITH MIN 3mm STEEL PLATE UNO AND NOT HOLED. WHERE SECTION IS TO BE HOT DIPPED GALVANISED, PROVIDE BREATHING HOLES AS REQUIRED IN NON VIEWABLE LOCATIONS. HOLLOW SECTIONS TO HAVE A MINIMUM STRENGTH GRADE OF 250MPa.
 - COMPACTION**
GROUND BENEATH SLAB SHALL BE NOMINALLY COMPACTED TO 95% MODIFIED MAXIMUM DRY DENSITY

REV	DATE	DESCRIPTION	BY	APPD
2	23.05.2022	ISSUED FOR CONSTRUCTION. REVISED AS CLOUDED.	LVA	JH
1	25.03.2022	ISSUED FOR CONSTRUCTION	LVA	JH

STATUS: **ISSUED FOR CONSTRUCTION**

pritchard francis
civil and structural engineering consultants
430 Roberts Road
Subiaco WA 6008
PO Box 2150
Subiaco WA 6904
Telephone: (08) 9382 5111
admin@pfrng.com.au

CLIENT	NSW NATIONAL PARKS & WILDLIFE								
PROJECT	NSW PARKS CONSERVATION FENCING								
TITLE	FERAL PROOF SWING GATE DETAILS								
SCALE	As indicated @ A1	DATE	MARCH 22	DESIGNED	JK	DRAWN	LVA	CHECKED	JH
JOB No	21-259	DRG No	S5.01	REV	2				

DISCLAIMER This report was prepared by Pritchard Francis in good faith exercising all due care and attention, but no representation or warranty, express or implied, is made as to the relevance, accuracy, completeness or fitness for purpose of this document in respect of any particular user's circumstances. Users of this document should satisfy themselves concerning its application to, and where necessary seek expert advice in respect of, their situation. The views expressed within are not necessarily the views of the Department of Planning and Environment and may not represent Department policy.
© Copyright State of NSW and the Department of Planning and Environment

PRINT IN COLOUR

GATE ISOMETRIC